

Mini-fix to connect Designer's Choice
 Install CAMS into the 15mm (just over 1/2") holes with the arrow facing the direction of the 3/8" through-hole.

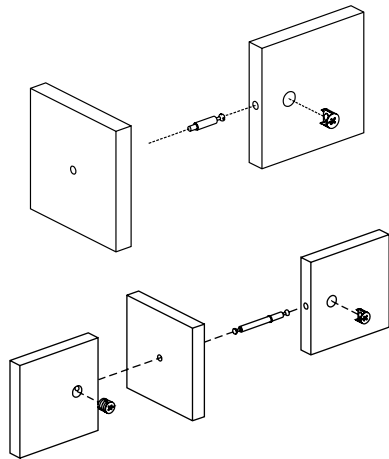

1. STARTER CONNECTION

To assemble (2) pieces perpendicular to each other (a back to a panel, a header to a side or a kickboard to side). Push CAMS into the holes. Screw DOWELS into the brass inserts. Slide the piece with the CAMS flush to the piece with the DOWELS protruding and tighten CAMS.

2. ADD-ON CONNECTION

To assemble (2) pieces edge-to-edge with a panel in-between. Install CAMS. Insert the longer end of the ADD-ON DOWEL through the in-between panel into the 3/8" through-holes on the first piece and tighten the CAM. The ADD-ON DOWEL should protrude through the in-between panel. Slide the second piece flush to the panel and tighten the CAM in the second panel.

Break-away of Designer's Choice Perimeter System run on page 69

