

prices: \$ wood / \$ stain / \$ melamine

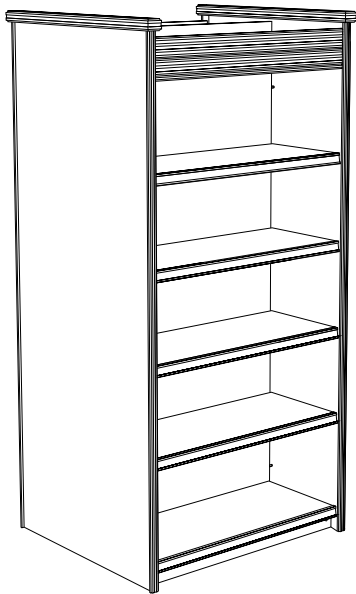

G. 5-level Gondola w/Shelves – Holds 60 cases
Taped Edge

Starter: 42" D x 50" W x 92" H
Add-on: 42" D x 49" W x 92" H
W*G-TR50-5LS8HT \$2,202 / \$2,685 / \$1,410 Str
W*G-TR49-5LA8HT \$1,870 / \$2,280 / \$1,197 Add
End Cap:
22" D X 40" W X 91" H – Holds 22-1/2 cases
W*E-TR40-5LE4HT \$981 / \$1,196 / \$628 End Cap
Pattern Moulding
Starter: 44" D x 50" W x 94" H
Add-on: 44" D x 49" W x 94" H
W*G-TR50-5LS8HP# \$2,597 / \$3,167 Str
W*G-TR49-5LA8HP# \$2,228 / \$2,717 Add
End Cap:
23" D X 40" W X 91" H – Holds 22 1/2 cases
W*E-TR40-5LE4HP# \$1,181 / \$1,440 End Cap

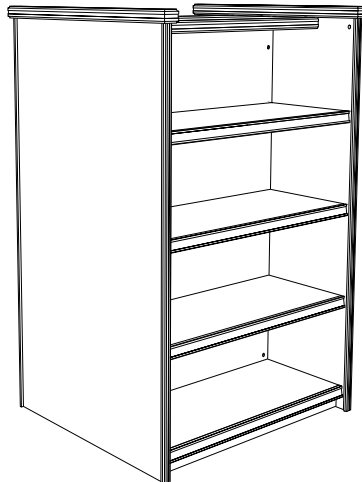

H. 4-level Gondola w/Shelves – Holds 48 cases
Taped Edge

Starter: 42" D x 50" W x 68" H
Add-on: 42" D x 49" W x 68" H
W*G-TR50-4LS6HT \$1,771 / \$2,160 / \$1,134 Str
W*G-TR49-4LA6HT \$1,508 / \$1,839 / \$965 Add
End Cap:
22" D X 40" W X 66" H – Holds 18 cases
W*E-TR40-4LE3HT \$771 / \$940 / \$493 End Cap
Pattern Moulding
Starter: 44" D x 50" W x 70" H
Add-on: 44" D x 49" W x 70" H
W*G-TR50-4LS6HP# \$2,093 / \$2,552 Str
W*G-TR49-4LA6HP# \$1,872 / \$2,283 Add
End Cap:
23" D X 40" W X 66" H – Holds 18 cases
W*E-TR40-4LE3HP# \$946 / \$1,154 End Cap

NEWConcept Wine Gondolas w/Shelves
Starter and add-on gondolas with Shelves.
Available with taped edge or pattern moulding (shown).



I. 3-level Gondola w/Shelves – Holds 36 cases
Taped Edge

Starter: 42" D x 50" W x 52" H
Add-on: 42" D x 49" W x 52" H
W*G-TR50-3LS4HT \$1,438 / \$1,754 / \$920 Str
W*G-TR49-3LA4HT \$1,231 / \$1,501 / \$788 Add
End Cap:
22" D X 40" W X 50" H – Holds 13-1/2 cases
W*E-TR40-3LE2HT \$601 / \$733 / \$385 End Cap
Pattern Moulding
Starter: 44" D x 50" W x 54" H
Add-on: 44" D x 49" W x 54" H
W*G-TR50-3LS4HP# \$1,731 / \$2,111 Str
W*G-TR49-3LA4HP# \$1,416 / \$1,727 Add
End Cap:
23" D X 40" W X 52" H – Holds 13-1/2 cases
W*E-TR40-3LE2HP# \$767 / \$935 End Cap

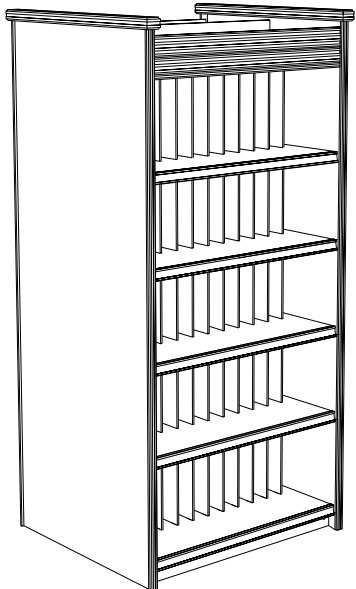

J. 5-level Gondola w/Dividers

120 Bins Hold 60 cases
Taped Edge
Starter: 42" D x 50" W x 92" H
Add-on: 42" D x 49" W x 92" H
W*G-TR50-5LS120BT \$3,068 / \$3,741 / \$1,964 Str
W*G-TR49-5LA120BT \$2,746 / \$3,349 / \$1,757 Add
End Cap:
22" D X 40" W X 88" H – 45 Bins Hold 22-1/2 cases
W*E-TR40-5L45BT \$1,256 / \$1,532 / \$804 End Cap
Pattern Moulding
Starter: 44" D x 50" W x 94" H
Add-on: 44" D x 49" W x 94" H
W*G-TR50-5LS120BP# \$3,543 / \$4,321 Str
W*G-TR49-5LA120BP# \$3,091 / \$3,770 Add
End Cap:
23" D X 40" W X 91" H – 45 Bins Hold 22-1/2 cases
W*E-TR40-5L45BP# \$1,489 / \$1,816 End Cap

NEWConcept Wine Gondolas w/Dividers

Starter and add-on gondola w/dividers. Dividers create bins to hold 4 bottles down and 2 bottles up. Available with taped edge or pattern moulding (shown). See page 175 for moulding patterns and coding instructions.



K. 4-level Gondola w/Dividers

96 Bins Hold 48 cases
Taped Edge
Starter: 42" D x 50" W x 68" H
Add-on: 42" D x 49" W x 68" H
W*G-TR50-4LS96BT \$2,491 / \$3,038 / \$1,594 Str
W*G-TR49-4LA96BT \$2,234 / \$2,724 / \$1,431 Add
End Cap:
22" D X 40" W X 66" H – 36 Bins Hold 18 cases
W*E-TR40-4L36BT \$1,034 / \$1,261 / \$661 End Cap
Pattern Moulding
Starter: 44" D x 50" W x 70" H
Add-on: 44" D x 49" W x 70" H
W*G-TR50-4LS96BP# \$2,858 / \$3,485 Str
W*G-TR49-4LA96BP# \$2,478 / \$3,022 Add
End Cap:
23" D X 40" W X 68" H – 36 Bins Hold 18 cases
W*E-TR40-4L36BP# \$1,198 / \$1,461 End Cap

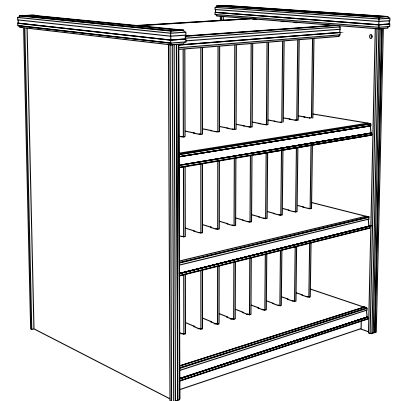

L. 3-level Gondola w/Dividers

72 Bins Hold 36 cases
Taped Edge
Starter: 42" D x 50" W x 52" H
Add-on: 42" D x 49" W x 52" H
W*G-TR50-3LS72BT \$1,949 / \$2,377 / \$1,554 Str
W*G-TR49-3LA72BT \$1,732 / \$2,112 / \$1,281 Add
End Cap:
22" D X 40" W X 50" H – 27 Bins Hold 13-1/2 cases
W*E-TR40-3L27BT \$821 / \$1,001 / \$637 End Cap
Pattern Moulding
Starter: 44" D x 50" W x 54" H
Add-on: 44" D x 49" W x 54" H
W*G-TR50-3LS72BP# \$2,257 / \$2,752 Str
W*G-TR49-3LA72BP# \$1,972 / \$2,405 Add
End Cap:
23" D X 40" W X 52" H – 27 Bins Hold 13-1/2 cases
W*E-TR40-3L27BP# \$994 / \$1,212 End Cap

*SPECIFY WOOD "O"=OAK, "M"=MAPLE,

"K"=OAK MELAMINE, "E"=MAPLE MELAMINE